

Endurance®

Datasheet

Highlights

- 4 year warranty
- Wide temperature range:
50 to 3200 °C (122 to 5792 °F)
- Sighting options:
 - Laser through the lens and Visible through the lens - Manual Variable focus
 - Video Camera through the lens and Visible through the lens - Manual Variable focus
 - LED through the lens and Visible through the lens - Manual Variable focus
- Superior optical resolution to 300:1
- LAN/Ethernet interface with PoE for communication with the sensor (ASCII, Video, and Webserver)
- Profinet Interface option
- Programmable relay output
- Fail safe alarm
- Isolated analog input/output
- Ambient temperatures to 315 °C (600 °F) with ThermoJacket enclosure
- Rugged stainless steel housing, IP65 (NEMA 4) rated
- Unique "dirty window" alarm
- Endurance software for remote configuration, remote monitoring and field calibration
- Single color and two colors models



Electrical Specifications

Inputs Contact input (peak/valley reset, Laser, LED), Analog input (emissivity, e-slope, background temperature) 0/4-20mA

Outputs Ethernet, Profinet 0/4-20 mA, max. load: 500 Ω RS485 (2-wire half duplex), networkable Relay, 48 V, 300 mA, response time < 2 ms

Power Supply 20 to 48 VDC, 500 mA Power over Ethernet (PoE)

General Specifications

Environmental Rating IP65 (IEC529) / NEMA-4

Ambient Temperature
 without cooling 0 to 65 °C (32 to 149 °F)
 E2R without cooling 0 to 60 °C (32 to 140 °F)
 with air cooling 0 to 120 °C (32 to 250 °F)
 with water cooling 0 to 175 °C (32 to 350 °F)
 with ThermoJacket 0 to 315 °C (32 to 600 °F)

Storage Temperature -20 to 70 °C (-4 to 158 °F)

Relative Humidity 10 to 95%, non-condensing

Shock IEC 68-2-27

Vibration IEC 68-2-6

Weight
 Optical head 1220 g (2.69 lbs)

Head with air/water cooled housing 2980 g (6.57 lbs)

Dimensions

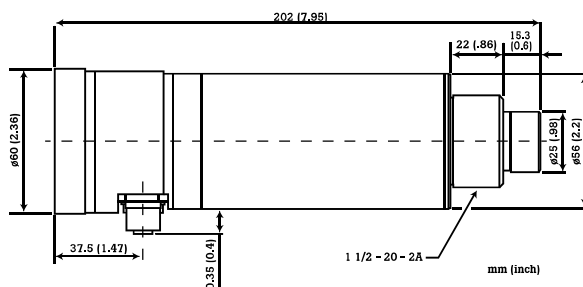

User Interface



Measurement Specifications

	E1R	E2R	E1M	E2M	E3M
Temperature Range	E1RL 600 to 1800 °C (1112 to 3272 °F) (2 color mode) 100 : 1	E2RL 250 to 1200 °C (482 to 2192 °F) 75 : 1	E1ML 400 to 1740 °C (752 to 3164 °F) 160 : 1	E2ML 250 to 1100 °C (482 to 2012 °F) 160 : 1	E3ML 50 to 1000 °C (122 to 1832 °F) 100 : 1
	550 to 1800 °C (1022 to 3272 °F) (single color mode) 100 : 1		E1MH 540 to 3000 °C (1004 to 5432 °F) 300 : 1	E2MH 450 to 2250 °C (842 to 4082 °F) 300 : 1	E3MH 150 to 1800 °C (302 to 3272 °F) 300 : 1
Spectral Response	1.0 μm nominal one/two color	1.6 μm nominal one/two color	1.0 μm nominal single color	1.6 μm nominal single color	2.4 μm nominal single color
Lens Options	600mm – ∞ (24" – ∞) (F2), 300 – 600mm (12 – 24") (F1), 190–300mm (7.5 – 12") (F0)				
Sighting	Visual/Laser, Visual/Camera, Visual/LED				
Accuracy	$\pm(0.5\% T_{\text{meas.}} + 2^{\circ}\text{C})$ with no attenuation	$\pm(0.5\% T_{\text{meas.}} + 2^{\circ}\text{C})$ with no attenuation	E1ML $\pm(0.3\% T_{\text{meas.}} + 1^{\circ}\text{C})$ > 450°C $\pm(2\% T_{\text{meas.}} + 2^{\circ}\text{C})$ < 450°C E1MH $\pm(0.3\% T_{\text{meas.}} + 1^{\circ}\text{C})$ > 650°C $\pm(2\% T_{\text{meas.}} + 2^{\circ}\text{C})$ < 650°C	E2ML $\pm(0.3\% T_{\text{meas.}} + 2^{\circ}\text{C})$ E2MH $\pm(0.3\% T_{\text{meas.}} + 1^{\circ}\text{C})$	$\pm(0.3\% T_{\text{meas.}} + 1^{\circ}\text{C})$ > 100°C $\pm(1\% T_{\text{meas.}} + 2^{\circ}\text{C})$ < 100°C
Repeatability	$\pm(0.3\% T_{\text{meas.}} + 1^{\circ}\text{C})$ $T_{\text{meas.}}$ in °C with no attenuation	$\pm(0.3\% T_{\text{meas.}} + 1^{\circ}\text{C})$ $T_{\text{meas.}}$ in °C with no attenuation	E1ML $\pm(0.1\% T_{\text{meas.}} + 1^{\circ}\text{C})$ > 450°C $\pm(1\% T_{\text{meas.}} + 1^{\circ}\text{C})$ < 450°C E1MH $\pm(0.1\% T_{\text{meas.}} + 1^{\circ}\text{C})$ > 650°C $\pm(1\% T_{\text{meas.}} + 1^{\circ}\text{C})$ < 650°C	$(0.1\% T_{\text{meas.}} + 1^{\circ}\text{C})$	$\pm(0.1\% T_{\text{meas.}} + 1^{\circ}\text{C})$ > 100°C $\pm(1\% T_{\text{meas.}} + 1^{\circ}\text{C})$ < 100°C
Temperature Resolution	Digital Output 0.1°C, Current Output <0.03°C / 16 bit				
Response Time	10 ms (95%)	20 ms (95%)	2 ms (95%)	2 ms (95%)	20 ms (95%)
Emissivity	0.100 to 1.100				
E-Slope	0.850 to 1.150		N/A		
Signal Processing	Peak Hold, Valley Hold, Averaging				

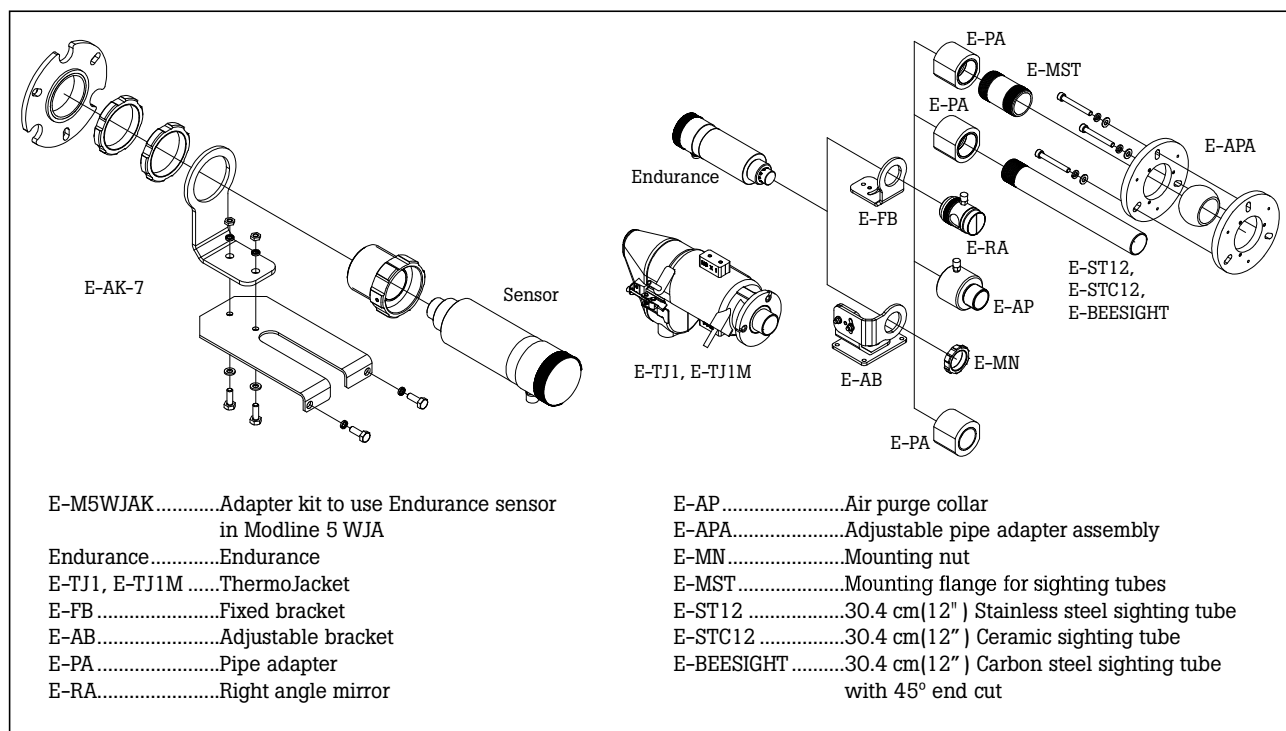

Options

Options must be specified at time of order.

- Water-cooled housing, including air purge collar
- Profinet communications

Accessories

The model includes a mounting nut, fixed bracket, end cap for display, operator's manual and Endurance software. Additional accessories are available (refer to the Endurance Accessory datasheet).

- Adjustable bracket (**E-AB**)
- Air purge collar (**E-AP**)
- SpotScan™ Accessory (**SSA or SSB**) to allow Endurance sensors to scan over a line
- ThermoJacket enclosure for ambient temperatures to 315 °C (600 °F) (**E-TJ1M** metric version) – see *ThermoJacket* documentation.
- Polarizing filter end cap (**E-PFEC**)
- Terminal block (**E-TB**)
- Switching power supply 24 VDC 1.3 A industrial power supply, DIN rail mount (**E-SYSPS**)
- Switching power supply in NEMA 4 enclosure 100 / 240 VAC 24 VDC, 1.1 A (**E-PS**)
- Power over Ethernet (**PoE**) Injector provides power and also acts as a single Ethernet hub (100/240 VAC input) (**E-PoE**)
- USB/RS485 Converter (**E-USB485**)
- Protective front window including O-ring (**E-PW**)

The Fluke Process Instruments Guarantee

The Endurance Series is supported by a 4 year warranty. With a network of trained representatives and agents in over one hundred countries and offices located in the U.S., Germany and China, we provide local service and support you can rely on time after time.

Fluke Process Instruments

Americas

Santa Cruz, CA USA
Tel: +1 800 227 8074 (USA and Canada, only)
+1 831 458 3900

solutions@flukeprocessinstruments.com

EMEA

Berlin, Germany
Tel: +49 30 4 78 00 80
info@flukeprocessinstruments.de

China

Beijing, China
Tel: +8610 6438 4691
info@flukeprocessinstruments.cn

Japan

Tokyo, Japan
Tel: +81 03 6714 3114
info@flukeprocessinstruments.jp

Asia East and South

India Tel: +91 22 62495028
Singapore Tel: +65 6799 5578
sales.asia@flukeprocessinstruments.com

Worldwide Service

Fluke Process Instruments offers services, including repair and calibration. For more information, contact your local office.

www.flukeprocessinstruments.com

© 2017 Fluke Process Instruments
Specifications subject to change without notice.
9/2017 6007052E